



Architecture & Planning

Client

Clemson University

Location

Anderson, South Carolina, USA

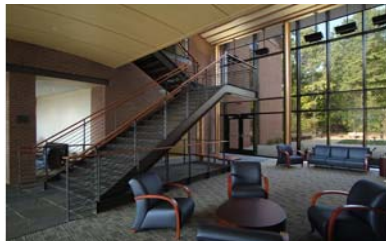

LEED® Certification at Advanced Materials Research Lab, Clemson University

Project Description

Clemson University selected IDC Architects, an affiliate of CH2M HILL, for their new Advanced Materials Research Lab located at Clemson's Science Technology Park. The design concept, as provided by Clemson, consolidates electronic instrument device and laser labs, chemistry labs, and cleanroom space to be used for both educational activities and industry research. Supporting these endeavors are research, faculty, and student offices, meeting rooms and a two-story centralized lobby created as a gathering space for the sharing and exchange of ideas.

IDC Architects is leading a team of engineers and lab consultants recognized for their expertise in creating flexible, cutting-edge research space. Planned as a LEED certified building, the project was executed on an accelerated schedule, and completed in the third quarter of 2004.

This research facility will attract researchers and industry leaders in order to meet the university's goal of becoming one of the top 20 public universities. To achieve this goal, considerable emphasis was placed on aesthetic values and the use of quality construction materials.

Technical design considerations emphasize control of vibration, EMI, and noise to support highly sophisticated equipment research activities, while building sustainability and flexibility into the design.